

Plan Information

Tenure Type	Freehold
Plan Type	Deposited Plan
Plan Purpose	Subdivision

Plan Heading

LOTS 301-311 AND ROADS

Locality and Local Government

Locality	STONEVILLE
Local Government	SHIRE OF MUNDARING

Planning Approval

Planning Authority	Western Australian Planning Commission
Reference	160609

Roads

New Road or Extension (Road Name Approval)	Yes
--	-----

Road Name	Locality
PIANO LANE	STONEVILLE

Survey Details

Survey Method	Special Survey
Field Records	158638
Declared as Special Survey Area	Yes

Survey Method Regulatory Statement

Survey carried out under Reg. 26A Special Survey Area Guidelines. See survey sheet(s) to determine the true final position and type of all survey marks placed for this plan.

Survey Certificate - Regulation 54

I hereby certify that this plan is accurate and is a correct representation of the ----  
(a) \* survey; and/or  
(b) \* calculations from measurements recorded in the field records;  
[\* delete if inapplicable]  
undertaken for the purposes of this plan and that it complies with the relevant written law(s) in relation to which it is lodged.

RYAN DERRICK SCRIVEN Licensed Surveyor	Date
---	------

Survey Organisation

Name	SCANLAN SURVEYS
Address	P.O. BOX 429 MIDLAND 6936
Phone	9250 2261
Fax	
Email	reception@scanlansurveys.com.au
Reference	8601/21

Former Tenure

New Lot / Land	Parent Plan Number	Parent Lot Number	Title Reference	Parent Subject Land Description
301-304, 311	D76164	LOT 86	1844-839	
305-307	D76164 DP107919	LOT 86 LOT 1871	1844-839 1793-859	
308-310	DP107919	LOT 1871	1793-859	

Former Tenure Interest and Notifications

Subject	Former Tenure	Action	Lots On This Plan	Origin	Endorsement	Comments
	1871/DP107919	Application to surrender		DOC D682906	EASEMENT TO SHIRE OF MUNDARING. SEE SKETCH ON VOL 1793 FOL 859. REGISTERED 26/2/1988.	
	1871/DP107919	Application to discharge		DOC K366680	NOTIFICATION CONTAINS FACTORS AFFECTING THE WITHIN LAND. LODGED 5/10/2007.	

New Memorials and Notifications

Subject	Purpose	Statutory Reference	Origin	Land Burdened	Benefit To	Comments
	NOTIFICATION (Hazards or Other Factors)	SEC. 165 OF THE P&D ACT 2005	DOC	LOT(S) 301-310		Bushfire Prone Area
	NOTIFICATION (Factors Affecting Use or Enjoyment of Land)	SEC. 70A OF THE TLA 1893	DOC	LOT(S) 301-310		No reticulated sewerage service

Vesting Lots

Land	Purpose	Statutory Reference	Origin	Comments
LOT 311	PEDESTRIAN ACCESSWAY	SEC. 152 OF THE P&D ACT 2005	THIS PLAN	



23 SPRING PARK ROAD  
MIDLAND, WA, 6056  
PO BOX 429, MIDLAND, 6936

PH: 08 9250 2261  
www.scanlansurveys.com.au  
reception@scanlansurveys.com.au

ADDITIONAL SHEETS  
ENDORSEMENT SHEET  
SURVEY SHEET

SHEET  
1 OF 2 SHEETS

VERSION NUMBER  
1

DEPOSITED PLAN  
422381

SURVEY CARRIED OUT UNDER REG 26A  
SPECIAL SURVEY AREA GUIDELINES  
SEE SURVEY SHEET(S) FOR SURVEY INFORMATION

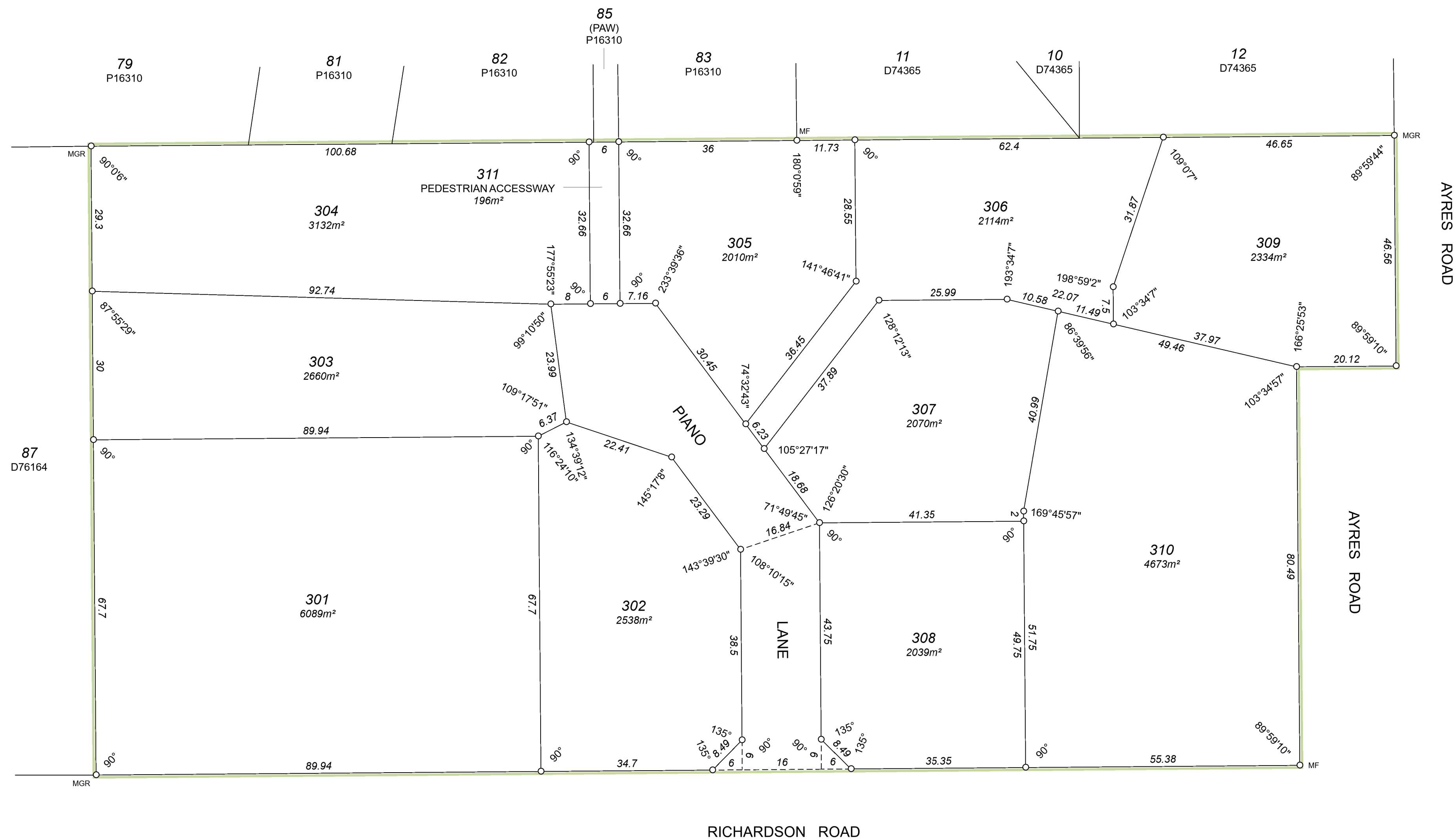

LIMITED IN DEPTH TO 609.6 METRES



SCALE 1:600 @ A2

5 0 25

ALL DISTANCES ARE IN METRES



23 SPRING PARK ROAD  
MIDLAND, WA, 6056  
PO BOX 429, MIDLAND, 6936

PH: 08 9250 2261  
www.scanlansurveys.com.au  
reception@scanlansurveys.com.au

ADDITIONAL SHEETS  
ENDORSEMENT SHEET  
SURVEY SHEET

SHEET 2 OF 2 SHEETS

VERSION NUMBER 1

DEPOSITED PLAN 422381